

DRAWING FOR CUSTOMER

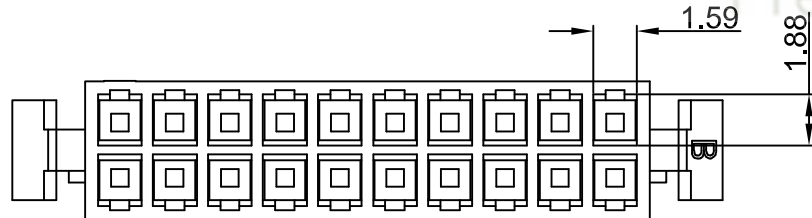
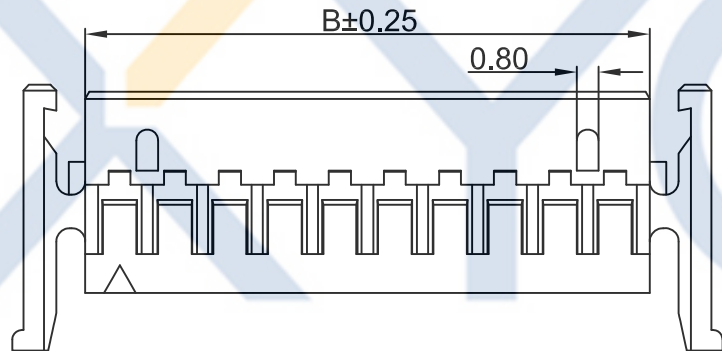
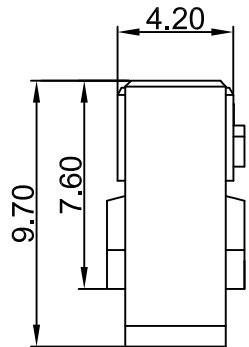
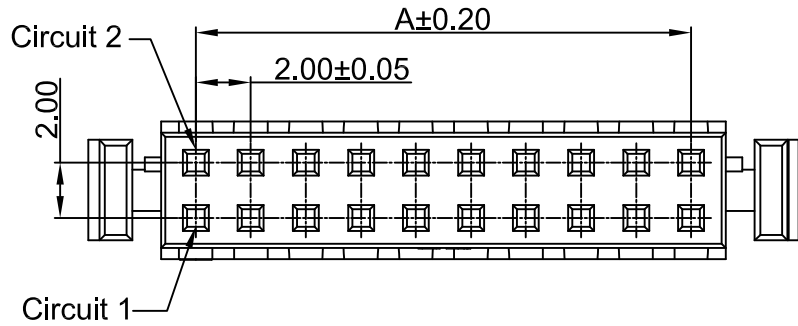

■SPEC.:

- Rated Voltage:250V AC,DC
- Rated Current:3A AC,DC
- Withstand Voltage:800V AC/minute
- Contact Resistance:10mΩ max
- Insulation Resistance:1000MΩ min
- Temperature Range:-25℃~+85℃

■Material:

- Insulator:PA66 UL94V-0
- Color:White

KB932-D XX H L 4 A

Double row Version
Pin No. Mold No.
Housing With Lock

Poles	Dimensions(mm)	
	A	B
2X02	2.00	4.50
2X03	4.00	6.50
2X04	6.00	8.50
2X05	8.00	10.50
2X06	10.00	12.50
2X07	12.00	14.50
2X08	14.00	16.50
2X09	16.00	18.50
2X10	18.00	20.50
2X11	20.00	22.50
2X12	22.00	24.50
2X13	24.00	26.50
2X14	26.00	28.50
2X15	28.00	30.50
2X16	30.00	32.50
2X17	32.00	34.50
2X18	34.00	36.50
2X19	36.00	38.50
2X20	38.00	40.50

XYCO 东莞市轩业电子科技有限公司
TEL: 0769-8297 9981/2/3 <http://www.XYCO.com.cn>

				TOLERANCE 公差		DRAWING 設計者		Devin		KB932-DXXHL4A	
2016-11-18		A		.X=±0.30 .XX=±0.20 .XXX=±0.10		CHECKED 審查		Thomas		PART NO. 料號	
DATE 日期	VER 版本	CHANGE HISTORY 變更歷史	CHANGED NAME 修改後料號	DRAWING 變更者	APPROVED 核准		William		DWG NO. 圖號	PE3605A	UNIT 單位
1	2	3	4	5	6	7	8	9			

mm	PRODUCT NAME 產品名稱	PHD PH2.0mm Wire To Board Housing With Lock
1	2	3